

Drilling Station

BST 460 / BST 320

The tensile force exerted by the polyethylene cable can be individually adjusted, for example, in order to reduce the feed pressure when working horizontally. Once the hole has been drilled, the machine automatically returns to the starting position.



The 80 mm high drill guide comprises six vertically located rollers with an iris-like adjusting mechanism. They enclose the bit without any backlash and thus provide perfect guidance. This arrangement prevents the bit from drifting.

Product features

- Intelligent drill guide
- For series drilling with drilling templates
- Single column
- With stop system thanks to parallel fence (see special accessories)

Application area

- Precision and series drilling
- Compatible materials include solid wood and laminated beams

Product description

MAFELL's drilling station not only offers supreme precision, compared with conventional drill jigs, but is also comprehensively revolutionizing drilling operations in solid wood. Its clever design, based on a rugged and lightweight aluminium column, cannot fail to impress.

The single column offers significant benefits: better view of the mark and drill tip, more space for bit changes, and the jamming that can occur during drilling is a thing of the past.

MAFELL is further demonstrating its ability to originate professional solutions, down to the last detail, and its understanding of practical needs. The continuously adjustable drill guide, with six locating elements, enables the drilling station to achieve unprecedented accuracy. As you would expect from MAFELL, the new drilling station is built exclusively from very high-quality materials, so that a long service life is assured.

Technical data

	BST 460	BST 320
Max. tool diameter at 0°	130 mm	130 mm
Max. drill length	460 mm	320 mm
Max. drilling depth	300 mm	160 mm
Drill guide clamping range	8 - 30 mm	8 - 30 mm
Weight	4,8 kg	4,5 kg
Collar diameter	43 mm	43 mm

Delivery specification:

Drilling Station BST 460	961211
Drilling Station BST 320	961210
Drilling Station BST 460 with Parallel fence, Copying insert, special drill bit for copying insert	961261
Drilling Station BST 320 with Parallel fence, Copying insert, special drill bit for copying insert	961251

Conversion table for inches, pounds, horsepower please find on page 132.

PG AZ
Price list page 17







The tensile force exerted by the polyethylene cable can be individually adjusted.

For series drilling and hole patterns, the insertion plate can be replaced by a copying insert. Ideal when working with drilling templates.

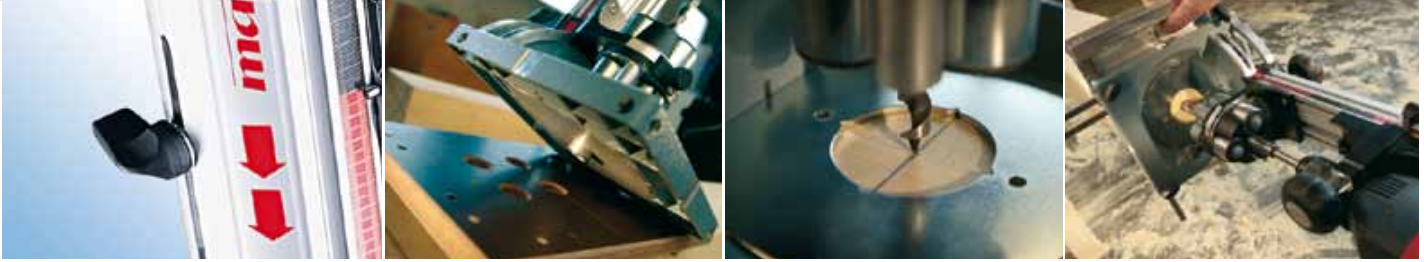
Notches to facilitate marking enable you to position the drill with great accuracy. Even when working at an angle, the drill tip always serves as the pivot axis.

The parallel fence, typically used for end grain drilling, is an ideal accessory to the face edge stop for series production purposes.



Accessories / Tools		
Image	Description	Ref. No.
	Parallel guide fence with face edge stop	204407
	Drilling machine retainer Ø 57 mm	204476
	Copying insert 24,8 / 18 mm	204290
	Special drill bit Ø 25 mm, total length 320 mm, for creating individual drilling templates	090276
	Lewis auger bit with hexagonal shank for BST 460 total length 460 mm (18 1/8 in.)	
	Ø 8 mm (5/16 in.)	090251
	Ø 10 mm (3/8 in.)	090252
	Ø 12 mm (1/2 in.)	090253
	Ø 14 mm (9/16 in.)	090254
	Ø 16 mm (5/8 in.)	090255
	Ø 18 mm (11/16 in.)	090256
	Ø 20 mm (13/16 in.)	090257
	Ø 22 mm (7/8 in.)	090258
	Ø 24 mm (15/16 in.)	090259
	Ø 26 mm (1 in.)	090260
	Ø 28 mm (1 1/8 in.)	090261
	Ø 30 mm (1 3/16 in.)	090262
	Lewis auger bit with hexagonal shank for BST 460, BST 320 total length 320 mm (12 5/8 in.)	
	Ø 6 mm (1/4 in.)	090279
	Ø 7 mm (1/4 in.)	090280
	Ø 8 mm (5/16 in.)	090263
	Ø 9 mm (3/8 in.)	090264
	Ø 10 mm (3/8 in.)	090265
	Ø 12 mm (1/2 in.)	090266

Accessories / Tools		
Image	Description	Ref. No.
	Ø 14 mm (9/16 in.)	090267
	Ø 16 mm (5/8 in.)	090268
	Ø 18 mm (11/16 in.)	090269
	Ø 20 mm (13/16 in.)	090270
	Ø 22 mm (7/8 in.)	090271
	Ø 24 mm (15/16 in.)	090272
	Ø 26 mm (1 in.)	090273
	Ø 28 mm (1 1/8 in.)	090274
	Ø 30 mm (1 3/16 in.)	090275
	Case with auger bits 460	093291
	6 pieces auger bits Ø 8, 10, 12, 14, 16, 18 mm	
	Case with auger bits 320	093290
	6 pieces auger bits Ø 8, 10, 12, 14, 16, 18 mm	

**All auger bits shown here:
The lead screw is guaranteed against breakage
in compliance with the general guarantee conditions.**

Detailed information about our products
www.mafell.com

Drilling Station

BST 650 S / BST 460 S

The tensile force exerted by the polyethylene cable can be individually adjusted, for example, in order to reduce the feed pressure when working horizontally. Once the hole has been drilled, the machine automatically returns to the starting position.

The S models can be precisely set to +/- 45° in either direction with the aid of a scale; and locked at 0°. The drill tip – at base plate height – always serves as the pivot axis.



The 80 mm high drill guide comprises six vertically located rollers with an iris-like adjusting mechanism. They enclose the bit without any backlash and thus provide perfect guidance. This arrangement prevents the bit from drifting.

Product features

- Tilts through 45° in either direction
- Intelligent drill guide
- For series drilling with drilling templates
- Single column
- With stop system thanks to parallel fence (see special accessories)
- Head of drill bit means tilting point

Application area

- Precision and series drilling
- Angle drilling
- Compatible materials include solid wood and laminated beams

Product description

MAFELL's drilling station not only offers supreme precision, compared with conventional drill jigs, but is also comprehensively revolutionizing drilling operations in solid wood. Its clever design, based on a rugged and lightweight aluminium column, cannot fail to impress.

The single column offers significant benefits: better view of the mark and drill tip, more space for bit changes, and the jamming that can occur during drilling is a thing of the past.

MAFELL is further demonstrating its ability to originate professional solutions, down to the last detail, and its understanding of practical needs. The continuously adjustable drill guide, with six locating elements, enables the drilling station to achieve unprecedented accuracy. As you would expect from MAFELL, the new drilling station is built exclusively from very high-quality materials, so that a long service life is assured.

Technical data

	BST 650 S	BST 460 S
Max. tool diameter at 0°	130 mm	130 mm
Max. tool diameter at 45°	100 mm	100 mm
Max. drill length	650 mm	460 mm
Max. drilling depth	455 mm	265 mm
Drill guide clamping range	8 - 30 mm	8 - 30 mm
Tilting adjustment, both sides	45 °	45 °
Weight	5,4 kg	5,0 kg
Collar diameter	43 mm	43 mm

Delivery specification:

Drilling Station BST 650 S	961216
Drilling Station BST 460 S	961215
Drilling Station BST 650 S with Parallel fence, Copying insert, special drill bit for copying insert	961281
Drilling Station BST 460 S with Parallel fence, Copying insert, special drill bit for copying insert	961271

Conversion table for inches, pounds, horsepower please find on page 132.

PG AZ
Price list page 17



The S models can be precisely set to +/- 45°.



For series drilling and hole patterns, the insertion plate can be replaced by a copying insert. Ideal when working with drilling templates.

Notches to facilitate marking enable you to position the drill with great accuracy. Even when working at an angle, the drill tip always serves as the pivot axis.

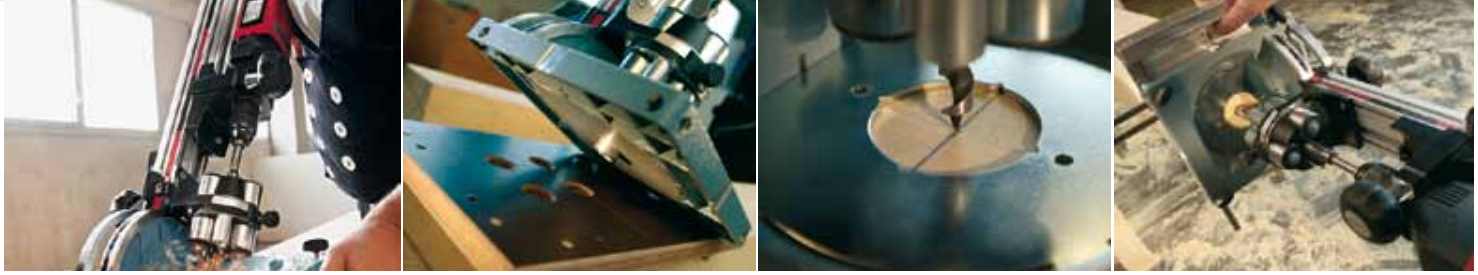
The parallel fence, typically used for end grain drilling, is an ideal accessory to the face edge stop for series production purposes.



Accessories / Tools		
Image	Description	Ref. No.
	Parallel guide fence with face edge stop	204407
	Drilling machine retainer Ø 57 mm	204476
	Copying insert 24,8 / 18 mm	204290
	Special drill bit Ø 25 mm, total length 320 mm, for creating individual drilling templates	090276
	Lewis auger bit with hexagonal shank for BST 650 S total length 650 mm (25 9/16 in.)	
	Ø 10 mm (3/8 in.)	090240
	Ø 12 mm (1/2 in.)	090241
	Ø 14 mm (9/16 in.)	090242
	Ø 16 mm (5/8 in.)	090243
	Ø 18 mm (11/16 in.)	090244
	Ø 20 mm (13/16 in.)	090245
	Ø 22 mm (7/8 in.)	090246
	Ø 24 mm (15/16 in.)	090247
	Ø 26 mm (1 in.)	090248
	Ø 28 mm (1 1/8 in.)	090249
	Ø 30 mm (1 3/16 in.)	090250
	Lewis auger bit with hexagonal shank for BST 650 S, BST 460 S total length 460 mm (18 1/8 in.)	
	Ø 8 mm (5/16 in.)	090251
	Ø 10 mm (3/8 in.)	090252
	Ø 12 mm (1/2 in.)	090253
	Ø 14 mm (9/16 in.)	090254
	Ø 16 mm (5/8 in.)	090255
	Ø 18 mm (11/16 in.)	090256

Accessories / Tools		
Image	Description	Ref. No.
	Ø 20 mm (13/16 in.)	090257
	Ø 22 mm (7/8 in.)	090258
	Ø 24 mm (15/16 in.)	090259
	Ø 26 mm (1 in.)	090260
	Ø 28 mm (1 1/8 in.)	090261
	Ø 30 mm (1 3/16 in.)	090262
	Lewis auger bit with hexagonal shank for BST 650 S, BST 460 S, BST 320 total length 320 mm (12 5/8 in.)	
	Ø 6 mm (1/4 in.)	090279
	Ø 7 mm (1/4 in.)	090280
	Ø 8 mm (5/16 in.)	090263
	Ø 9 mm (3/8 in.)	090264
	Ø 10 mm (3/8 in.)	090265
	Ø 12 mm (1/2 in.)	090266
	Ø 14 mm (9/16 in.)	090267
	Ø 16 mm (5/8 in.)	090268
	Ø 18 mm (11/16 in.)	090269
	Ø 20 mm (13/16 in.)	090270
	Ø 22 mm (7/8 in.)	090271
	Ø 24 mm (15/16 in.)	090272
	Ø 26 mm (1 in.)	090273
	Ø 28 mm (1 1/8 in.)	090274
	Ø 30 mm (1 3/16 in.)	090275
	Case with auger bits 650 093292 5 pieces auger bits Ø 12, 14, 16, 18, 20 mm	
	Case with auger bits 460 093291 6 pieces auger bits Ø 8, 10, 12, 14, 16, 18 mm	
	Case with auger bits 320 093290 6 pieces auger bits Ø 8, 10, 12, 14, 16, 18 mm	
All auger bits shown here: The lead screw is guaranteed against breakage in compliance with the general guarantee conditions.		
Detailed information about our products www.mafell.com		